

[illegible]

ELEVATION 2 DOOR LEAVES FOLDING TO ONE SIDE

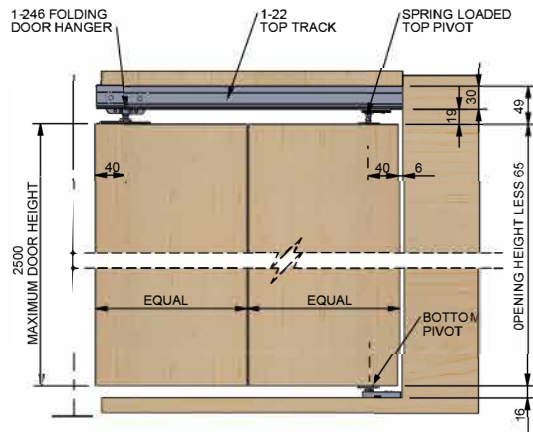
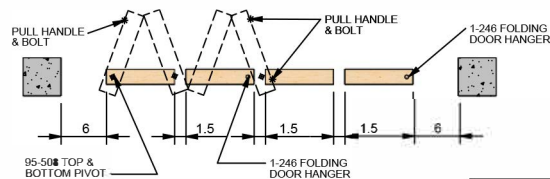

PLAN SHOWING FOUR LEAVES TO ONE SIDE

© 1985
DRG No 19656

The image contains three technical drawings of a door system:

- SECTION THROUGH OPENING:** A vertical cross-section showing the door's movement. Key components include the 1-22 TOP TRACK, 1-246 FOLDING DOOR HANGER, 95-523 Hinges, and BOTTOM PIVOT SLIDE & HOUSING SCREWED TO FLOOR. Dimensions include an opening height of 65, a door thickness of 20 to 40, and hinge spacing of 12 to 22.
- PLAN OF DOORS:** A top-down view showing two door configurations:
 - 1½ LEAVES FOLDING TO ONE SIDE:** Shows three door leaves with dimensions for hinge spacing (1.5) and leaf width (6).
 - 3½ LEAVES FOLDING TO ONE SIDE:** Shows five door leaves with dimensions for hinge spacing (1.5) and leaf width (6).
- DETAILS:** Two side views of the door hanger and hinge assembly. The left detail shows the 1-246 FOLDING DOOR HANGER and 95-508 TOP AND BOTTOM PIVOTS. The right detail shows the 95-523 HINGE 3 PER JOINT and 95-508 TOP AND BOTTOM PIVOT.

At the bottom right, there is a date stamp: © 1985 DRS No. 19657.

Technical drawing of the 1-22 Track system, showing front and side views with dimensions and part numbers.

Front View Dimensions:

- Top track length: 600 MAX
- Bottom track length: 600 MAX
- Left side track length: 40
- Right side track length: 40
- Bottom track offset: 6

Side View Dimensions:

- Top track height: 16 MIN, 22 MAX
- Bottom track height: 12 MIN, 22 MAX
- Track width: 20-40
- Track depth: 2500 MAX

Part Numbers:

- 1-22 TRACK
- 1-246
- 95-508T
- 95-508B
- 1-100

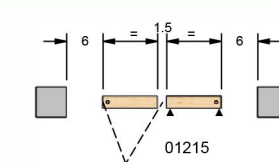
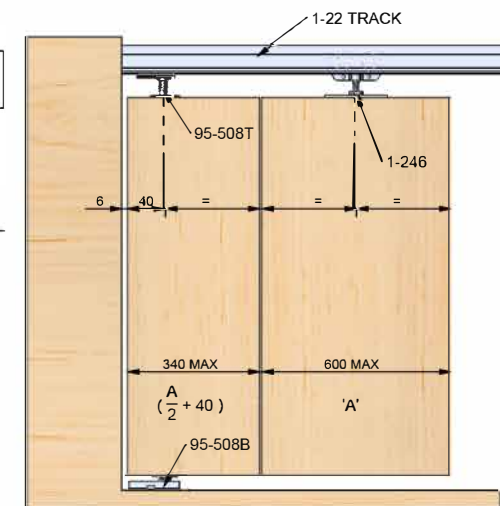

0121

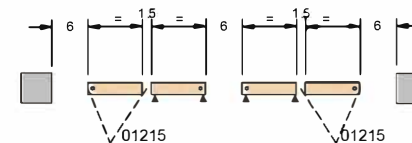

215

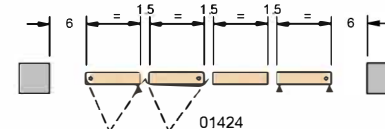
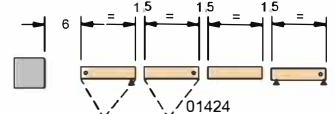
 ∇ 

\ / 01

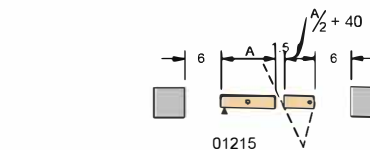

012

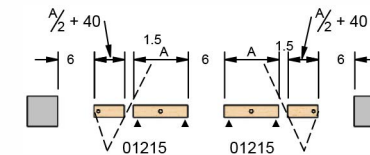

V 012

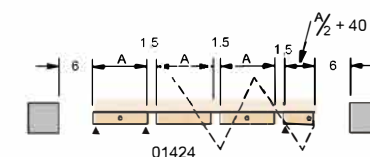

01.

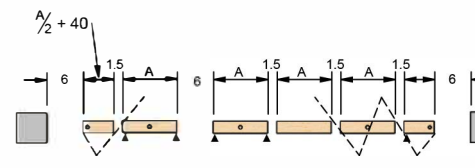

01215

01424

PART No. 10017.01 (9. 7)



TRACK LENGTH (m)	PITCH 'A'	No. OF HOLES
1.5	350mm	5
2.4	328mm	8

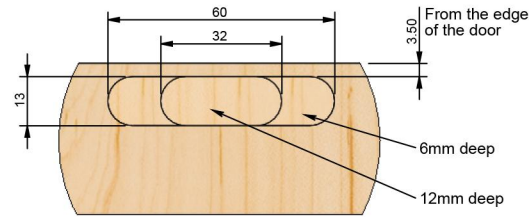

Hinge Cut-Out

Fit top and bottom pivots into holes and screw in long wood screws.

Fit hanger with door plate surface mounted.

Hinge doors together with 3 hinges per joint as shown. Doors over 2100mm high will require 4 hinges per joint.

Fit track to wall with the bracket and screws or directly through the track to the top support using suitable fixings as shown overleaf.

Locate top pivot centre line, 46mm from jamb, plumb down locate and fix bottom pivot to floor.

Engage bottom door pivot into floor housing. Depress spring loaded top pivot and engage in bush in top housing.

NOTE: When installing four door systems, sliding the doors into the track hinged in pairs before connecting to make a four door set.

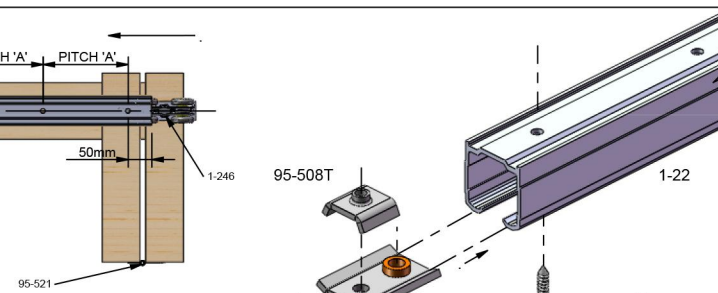

95-508B

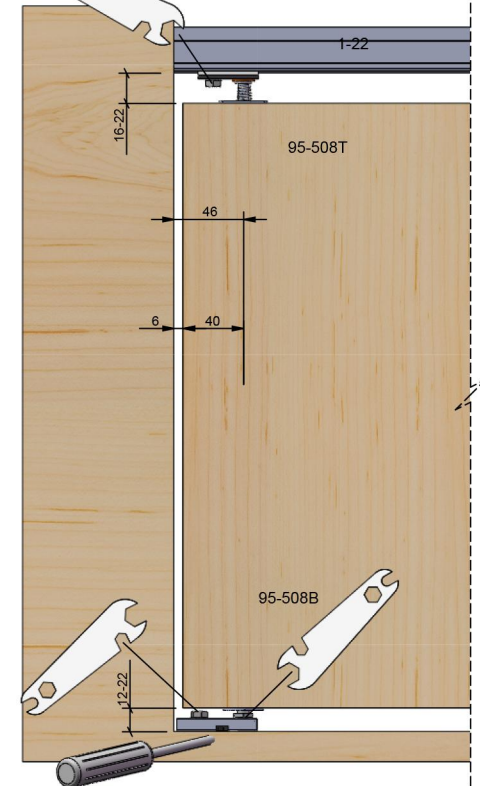

Doors over 450mm wide, or with weight in excess of 15kg, need stabilizing with 41-346 door guide fitted plumb under top hanger(s) and engaging 41-2 floor channel. Minimum door thickness must be 30mm. (Not included in standard kits).

